



**Pump specifications:**

Type.....	BA75 D220
Max. flow .....	100 m <sup>3</sup> /hour (440 US GPM)
Max. pressure .....	17 mwc (56 ft.)
Solids handling .....	42 mm (1,65")
Impeller type .....	Open impeller
Priming system .....	BBA MP50
Engine .....	Hatz 1D81Z
Emission standard .....	Stage V
Canopy .....	L9-15
Connections.....	3" quick couplings
Sound level.....	Approx. 50 dB(A) at 10 m
Dry weight.....	875 kg (1925 lbs.)

**FEATURES**

**BA auto prime pump**

The BA range of pumps has been designed with a clear focus on reliability, efficiency and durability. Featuring a 100% mechanical priming system, the BA series pumps quickly prime and re-prime, even from dry conditions. The heavy build style of both pump and canopy make the BA range perfect for use in the strenuous contractor market.

**World-class performance**

The BA range is built to be deployed on the most demanding dewatering and sewage bypassing applications. Using high efficiency pumps and state-of-the-art diesel engines, the pumps offer maximum performance at minimal cost, fully in-sync with the company philosophy of "Lowest cost of ownership".

**Sustainability**

- High efficiency pumps minimising fuel consumption
- Corrosion free hot dip galvanized canopy
- Corrosion free composite door panels
- 100% Oil-spill free priming system
- Fully bundled unit eliminating fuel/oil spills at all times

**Complete package designed & built by BBA Pumps**

- Complete in-house design & production
- Over 60 years of experience in the market
- Extensive testing facility in-house
- Contemporary & functional design
- Durable & eco-friendly materials
- Custom builds available

**After sales service & product support**

- Single supplier for parts, spares & accessories
- Dedicated customer help-desk (24h service)
- Dedicated service department in-house
- Global parts distribution network
- Optional global on-site servicing
- Extensive training options available (technical & commercial), on-site or in-house

**PERFORMANCE CURVES (1500 RPM)**

Continuous duty according ISO 9906

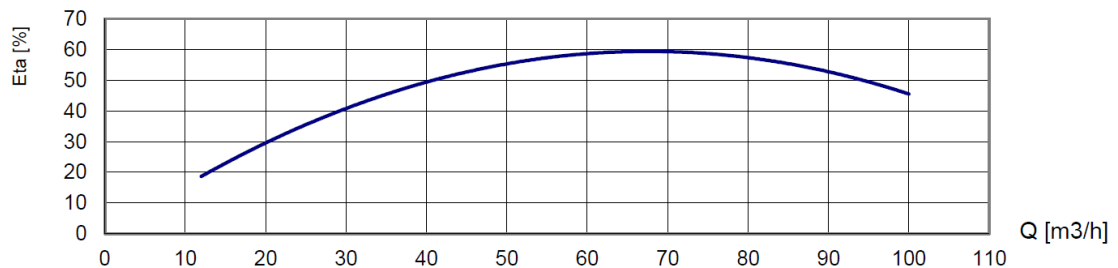
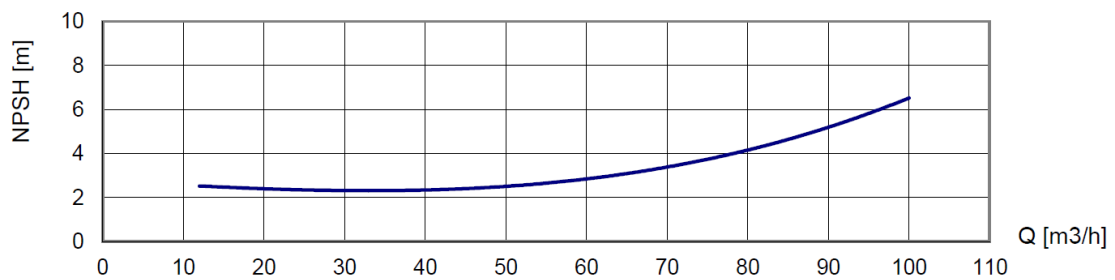
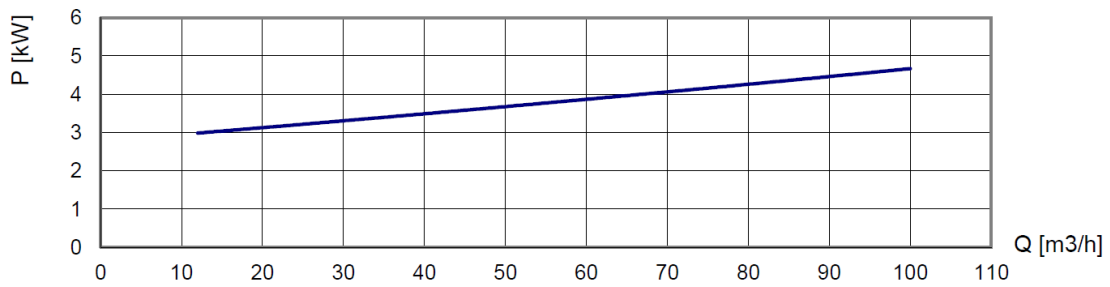
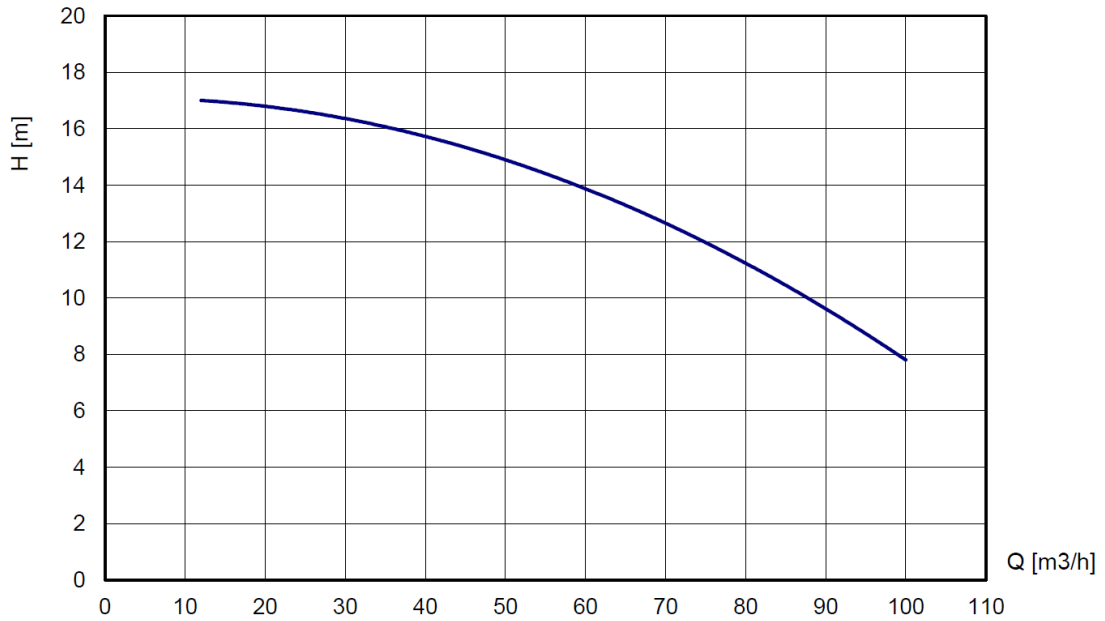

**STANDARD TECHNICAL SPECIFICATIONS**

**BBA auto prime pump**

Pump type.....BA75 D220  
 Max. flow..... 100 m<sup>3</sup>/hour (440 US GPM)  
 Max. head..... 17 mwc (56 feet)  
 Impeller type ..... Open impeller  
 Solids handling ..... 42 mm (1.65 inch)  
 Pump casing ..... St. 37 galvanized  
 Impeller ..... Cast iron GG20  
 Wear plate ..... Cast iron GG20  
 Pump shaft..... C45  
 Shaft seal..... Mechanical seal  
 Seal faces ..... Tung/Tung  
 Seal rubber ..... Viton



**BBA priming system**

Pump type.....BBA MP50 Diaphragm pump  
 Air handling capacity ..... 50 m<sup>3</sup>/h (30 CFM)  
 Max. vacuum ..... 8.5 m (29 inHg)  
 Drive ..... Toothed belt (continuous drive)  
 Float box ..... St. 37 galvanized  
 Float..... Stainless steel  
 Non return valve ..... Cast iron GG25



**Engine**

Engine brand ..... Hatz  
 Engine type..... 1D81Z electric start  
 Power..... 5.5 kW (7.5 Hp)  
 Engine speed..... 1300 - 1500 RPM  
 Fuel consumption ..... 245 g/kWh  
 Displacement..... 0.667 l (40,7 cu.in.)  
 Number of cylinders..... 1  
 Cooling system ..... Air cooled  
 Starting method ..... Electric start/stop  
 Emission level..... Stage V



**Control panel**

- Auto start/stop system
- Two float switches included (10 m cable)
- Switch Manual-0-Auto
- Hour counter
- Warning lights

**Fuel system**

- Composite fuel tank 120 Litres (32 US Gallon)
- Fuel tank cap Ø 60 mm (2.5 inch)
- Mechanical fuel injection system
- Fuel filter / water separator

**Electrical system & safety features**

- Nominal voltage 12 Volt
- Premium quality battery
- Low oil pressure shut down

## CANOPY L9-15

### BBA Super Silent Canopy

- Canopy type.....L9-15
- Dimensions L x W x H ..... 1500 x 940 x 1228 mm
- Dimensions L x W x H .....59 x 37 x 48,3 inch
- Basic frame ..... Hot dip galvanized
- Doors ..... 6 easy-access doors (lockable)
- Roof panel ..... Composite
- Fuel tank ..... Composite net 120 ltr (32 US Gallon)
- Fuel tank autonomy ..... 85 hours (at 1500 rpm.)
- Fuel tank cap ..... 60 mm (2.5 inch)
- Lifting point ..... Fitted with single lifting point
- Forklift pockets..... Fitted with 2 forklift pockets
- Stackable ..... Canopy is stackable
- Connections..... Please consult "auxiliary items"
- Exhaust system ..... Fully integrated in canopy
- Documentation box..... BBA user manual and warranty book

### BBA E-lift® system

The L9-15 canopy has been fitted with the BBA E-lift® system. By removing the roof panel, the pump and diesel engine as a whole can be removed from the canopy effortlessly allowing easy preventative maintenance on the pump and diesel engine. In addition, as the canopy is not fitted with padding or insulation materials, it can be cleaned quickly using a pressure washer.

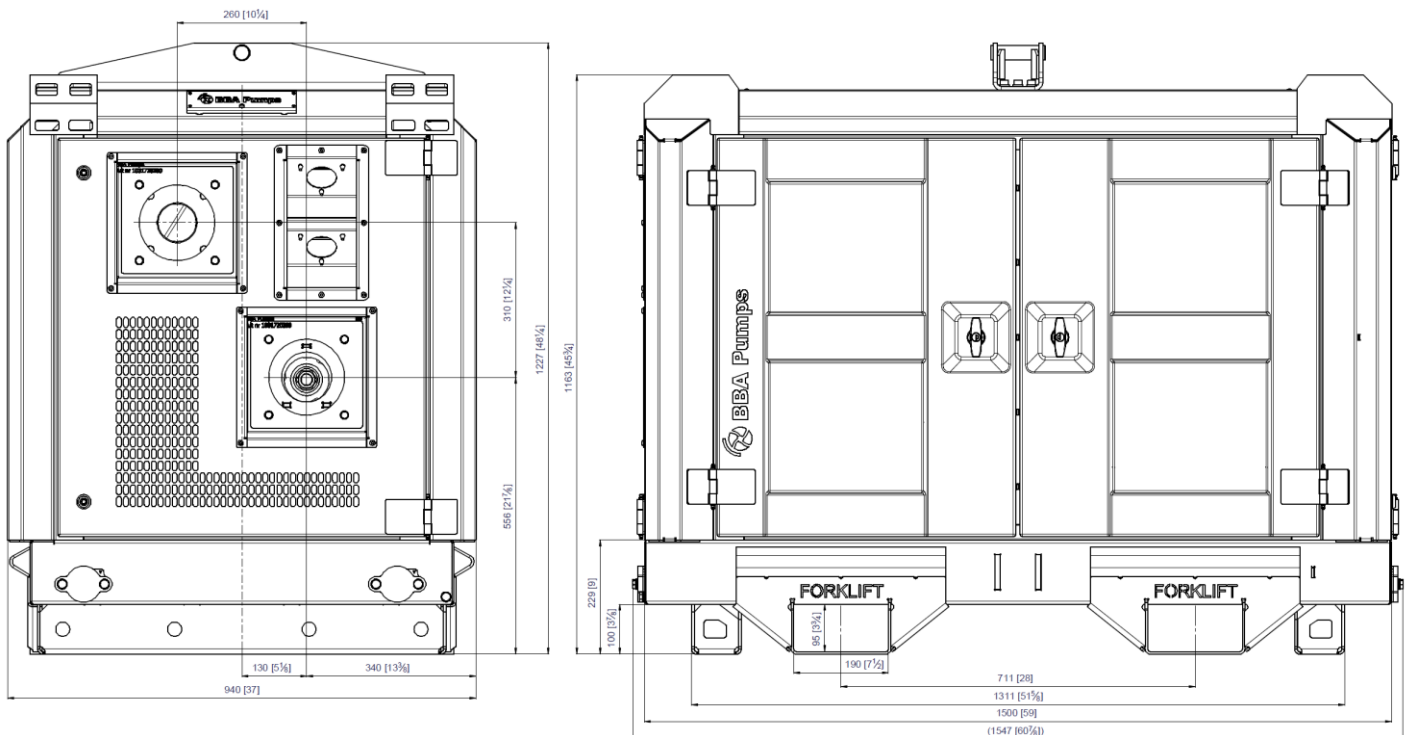

Actual dimensions (in mm and inches) may vary depending on selected quick couplings.

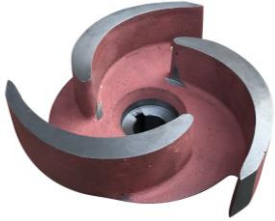

**Open impeller**  
Robust open impeller with large 42 mm free passage in combination with heavy duty wear plate for a long working life.



**Priming system**  
Diaphragm pump, air-cooled, water-resistant and oil-spillage free. Air capacity of 50 m<sup>3</sup> per hour.



**Fuel tank**  
Fully bunded, corrosion-free, 120 liter, high-density polyethylene (HDPE) fuel tank.

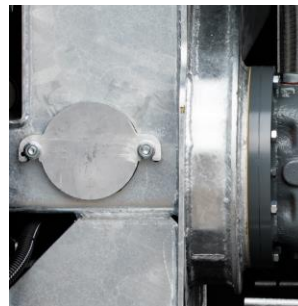

**Large inspection covers**  
Easy access to float box, impeller and non-return valve.

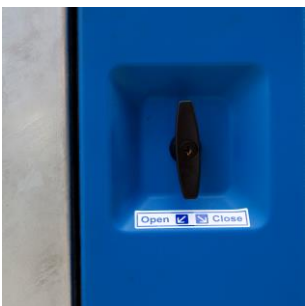

**Safety**  
Extremely durable and lockable T-locks offering perfect grip.



**4 Year limited warranty**  
The BBA limited warranty covers years or operating hours whichever occurs first. For more details please consult the BBA warranty book.

Pictures used are for illustration purposes only.

**AUXILIARY ITEMS (configurable)**
**Discharge connections**

Art.nr.		Ø inch	Ø mm	Connection	
26089	30° male (ball)	3	75	System C	
26102*	20° male (ball/lever)	3	75	System B	
26090	30° female (cup)	3	75	System B	
32345	30° ANSI flange	3	75	Flange	

\*To open the front door the connection has to be removed.

**Suction connections**

Art.nr.		Ø inch	Ø mm	Connection	
26089	30° male (ball)	3	75	System C	
26090	30° female (cup)	3	75	System B	
17123*	20° male (ball)	4	100	System C	
5080878*	30° male (ball)	4	100	System B	
14056	20° female (cup)	4	100	System B	
5080880*	30° DIN flange	4	100	Flange	

\*To open the front door the connection has to be removed.

**Suction hoses**

Art.nr.	BBA Flex rubber suction hose	Ø inch	Connection	
26662	3 meter hose with male x female	3	System C	
26671	4 meter hose with strainer x female	3	System C	
26672	3 meter hose with male x female	3	System B	
26673	4 meter hose with strainer x male	3	System B	

**Recommended suction pipe ID vs flow rates by pipe dimension (maximum velocity = 4 m/sec)**

m <sup>3</sup> /h	L/sec	2" 50	3" 75	4" 100	5" 125	6" 150	8" 200
28.8	8	4.07	1.81	1.02	0.65	0.45	0.25
36	10	5.09	2.26	1.27	0.81	0.57	0.32
43.2	12	6.11	2.72	1.53	0.98	0.68	0.38
50.4	14	7.13	3.17	1.78	1.14	0.79	0.45
57.6	16	8.15	3.62	2.04	1.30	0.91	0.51
64.8	18	9.17	4.07	2.29	1.47	1.02	0.57
72	20	10.19	4.53	2.55	1.63	1.13	0.64
90	25	12.73	5.66	3.18	2.04	1.41	0.80
108	30	15.28	6.79	3.82	2.44	1.70	0.95

Myynti: Aquator Oy  
 puh. 044 788 1620  
 puh. 044 088 1620  
 info@aquator.fi

**AQUATOR**  
 water technologies